

- A PUBLIC WORKS SITE AREA ENLARGEMENT
- B RIVER DEVELOPMENT AREA ENLARGEMENT
- C SOUTH VIADUCT DEVELOPMENT AREA ENLARGEMENT
- D CENTRAL AVENUE AREA ENLARGEMENT
- E FARIBULT HOUSE/LIBRARY AREA ENLARGEMENT

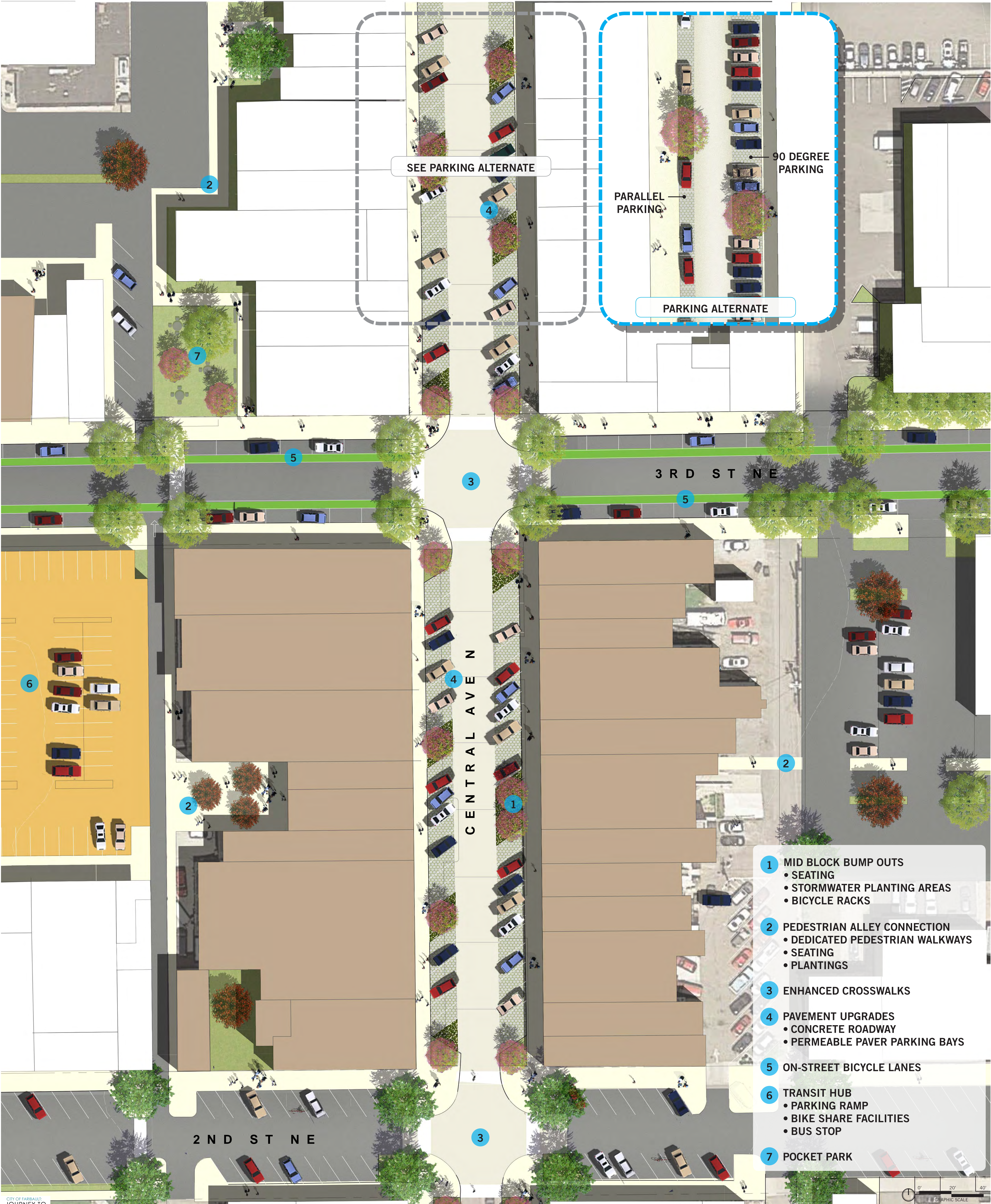

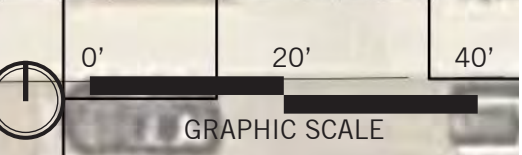

- 1 MID BLOCK BUMP OUTS
  - SEATING
  - STORMWATER PLANTING AREAS
  - BICYCLE RACKS
- 2 PEDESTRIAN ALLEY CONNECTION
  - DEDICATED PEDESTRIAN WALKWAYS
  - SEATING
  - PLANTINGS
- 3 ENHANCED CROSSWALKS
- 4 PAVEMENT UPGRADES
  - CONCRETE ROADWAY
  - PERMEABLE PAVER PARKING BAYS
- 5 ON-STREET BICYCLE LANES
- 6 TRANSIT HUB
  - PARKING RAMP
  - BIKE SHARE FACILITIES
  - BUS STOP
- 7 POCKET PARK





- 1 MID BLOCK BUMP OUTS
  - SEATING
  - STORMWATER PLANTING AREAS
  - BICYCLE RACKS
- 2 PAVEMENT UPGRADES
  - CONCRETE ROADWAY
  - PERMEABLE PAVER PARKING BAYS









### CENTRAL AVE SECTION

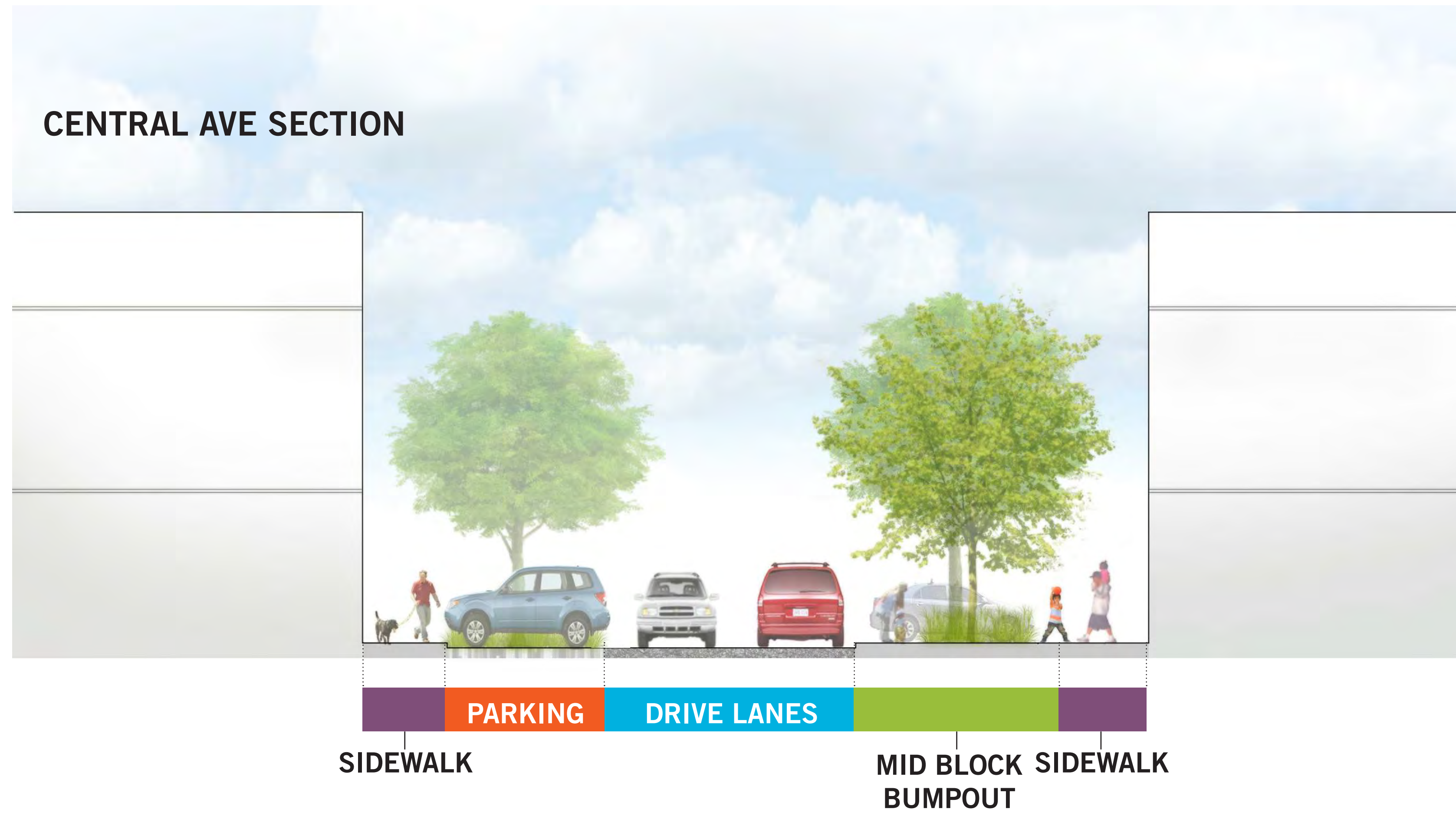

### ON STREET BIKE LANE SECTION

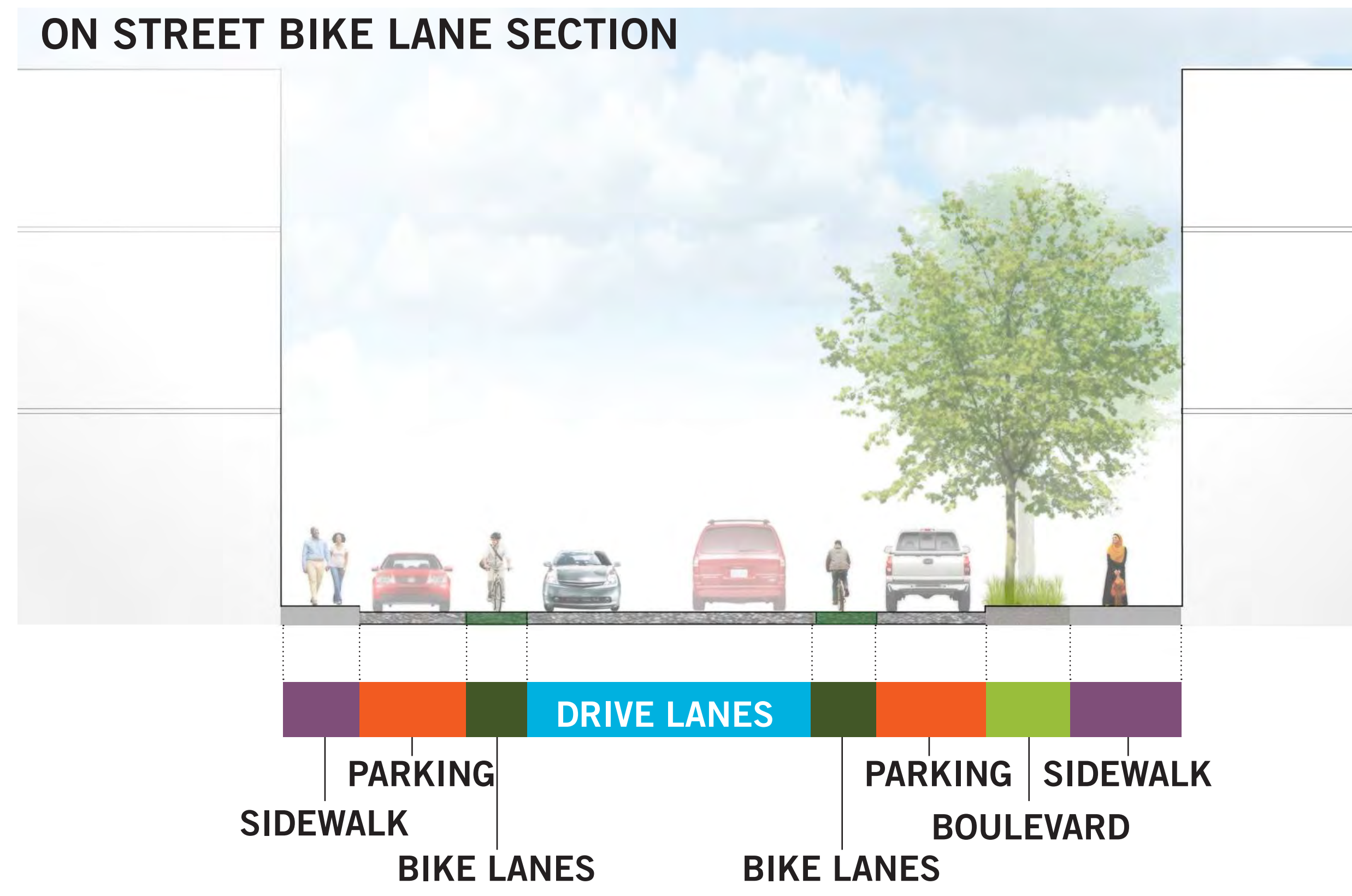

### GREEN ROUTE SECTION

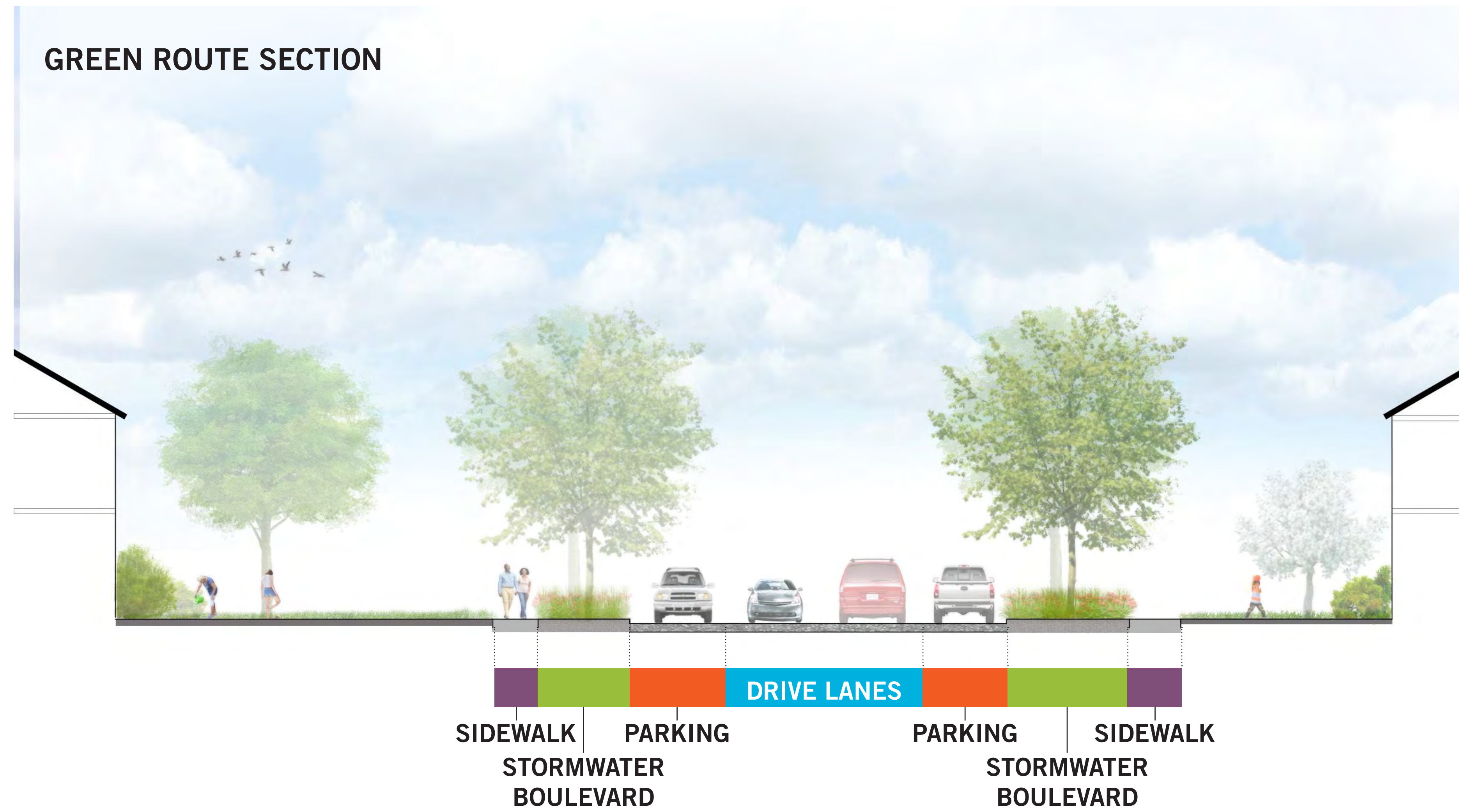



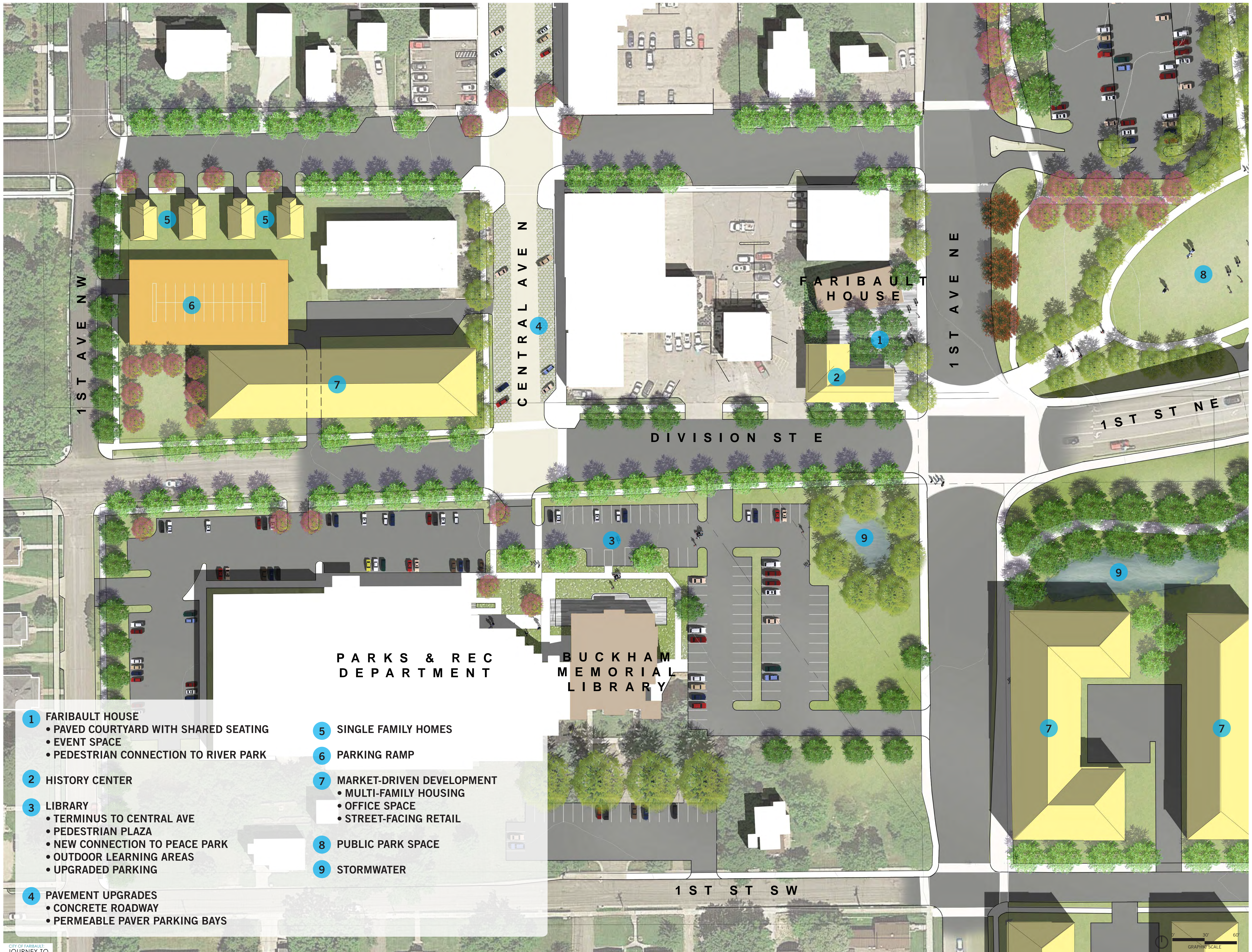

- 1 FARIBAULT HOUSE**
- PAVED COURTYARD WITH SHARED SEATING
  - EVENT SPACE
  - PEDESTRIAN CONNECTION TO RIVER PARK

- 2 HISTORY CENTER**

- 3 LIBRARY**
- TERMINUS TO CENTRAL AVE
  - PEDESTRIAN PLAZA
  - NEW CONNECTION TO PEACE PARK
  - OUTDOOR LEARNING AREAS
  - UPGRADED PARKING

- 4 PAVEMENT UPGRADES**
- CONCRETE ROADWAY
  - PERMEABLE PAVER PARKING BAYS

- 5 SINGLE FAMILY HOMES**

- 6 PARKING RAMP**

- 7 MARKET-DRIVEN DEVELOPMENT**
- MULTI-FAMILY HOUSING
  - OFFICE SPACE
  - STREET-FACING RETAIL

- 8 PUBLIC PARK SPACE**

- 9 STORMWATER**



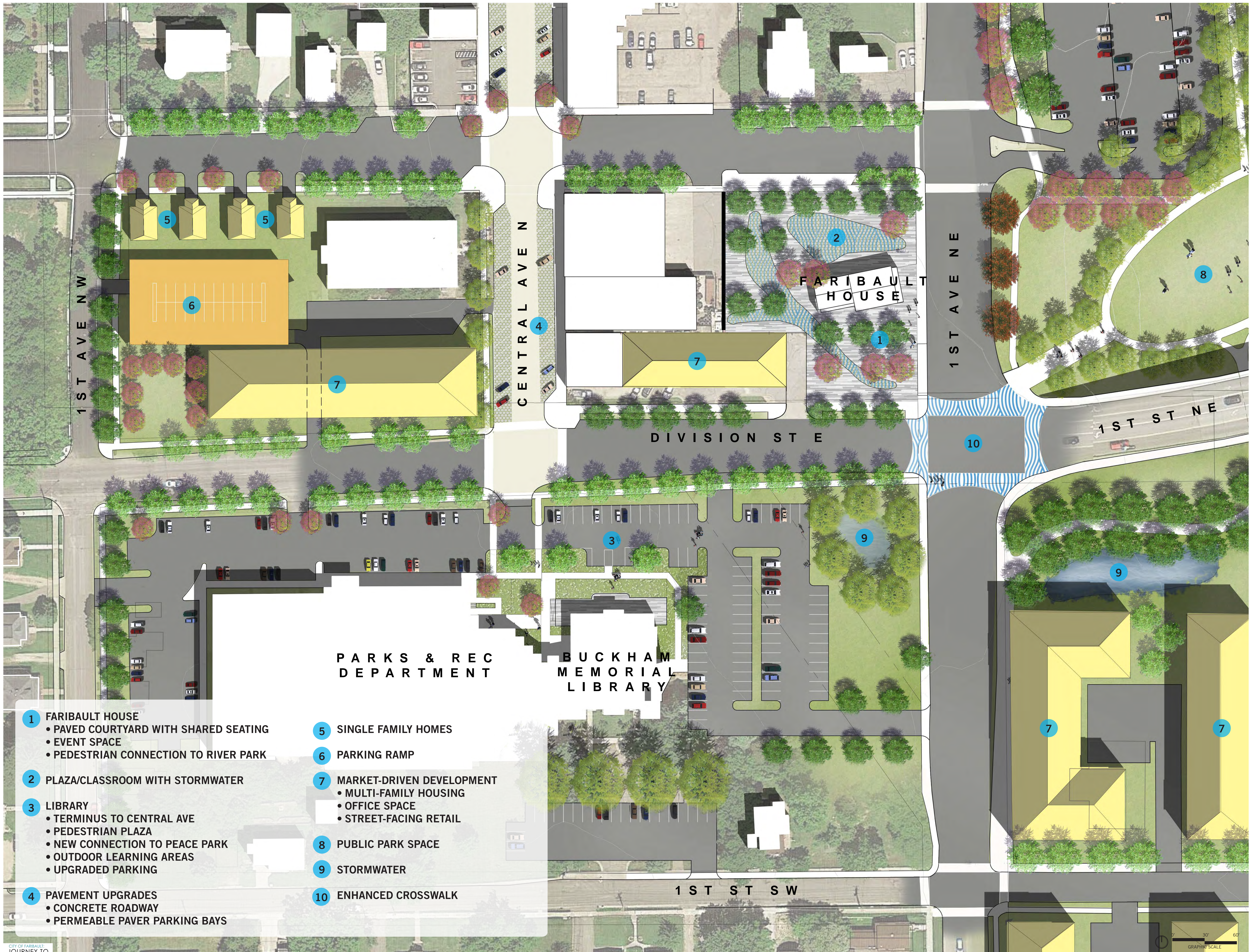



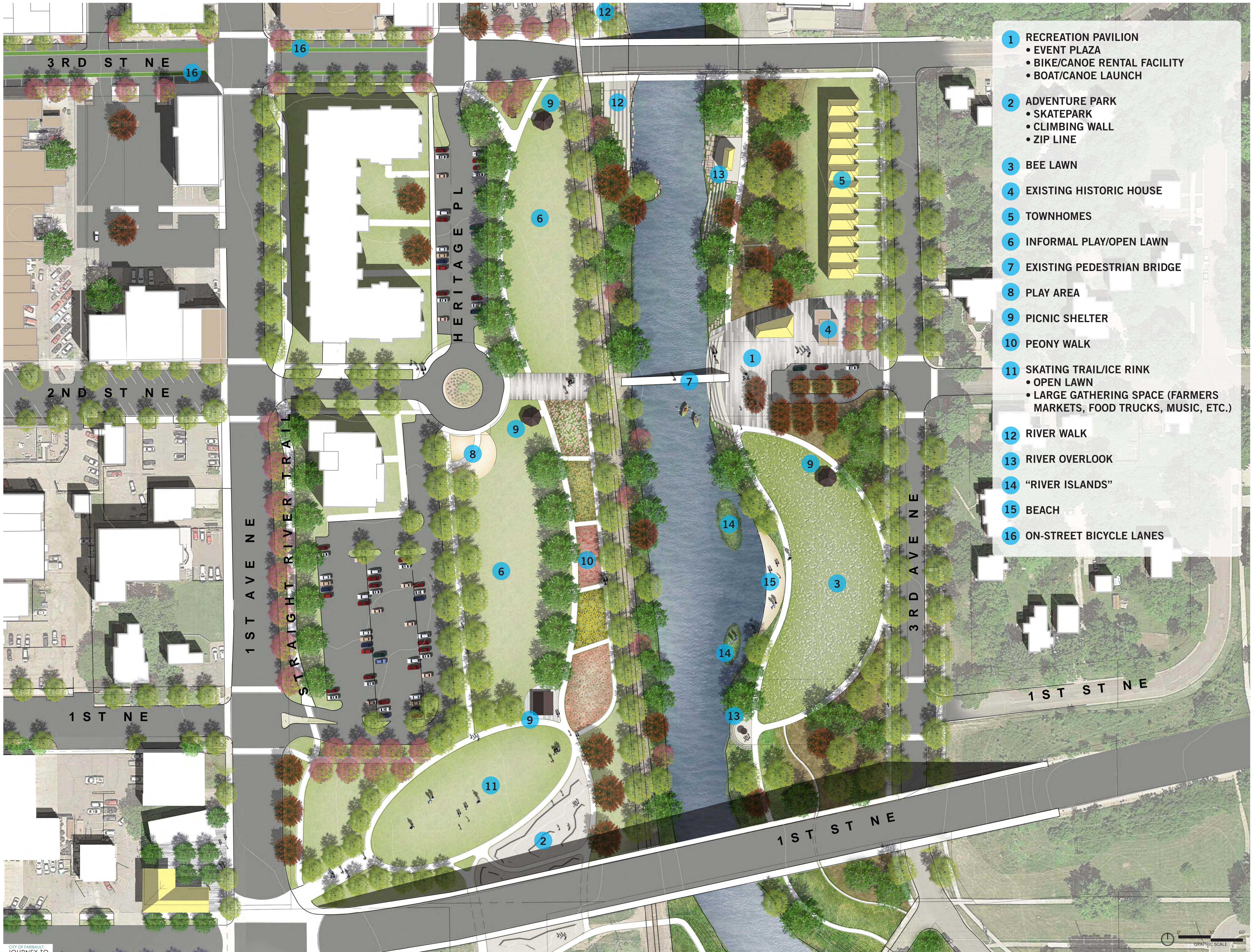

- 1 RECREATION PAVILION
  - EVENT PLAZA
  - BIKE/CANOE RENTAL FACILITY
  - BOAT/CANOE LAUNCH
- 2 ADVENTURE PARK
  - SKATEPARK
  - CLIMBING WALL
  - ZIP LINE
- 3 BEE LAWN
- 4 EXISTING HISTORIC HOUSE
- 5 TOWNHOMES
- 6 INFORMAL PLAY/OPEN LAWN
- 7 EXISTING PEDESTRIAN BRIDGE
- 8 PLAY AREA
- 9 PICNIC SHELTER
- 10 PEONY WALK
- 11 SKATING TRAIL/ICE RINK
  - OPEN LAWN
  - LARGE GATHERING SPACE (FARMERS MARKETS, FOOD TRUCKS, MUSIC, ETC.)
- 12 RIVER WALK
- 13 RIVER OVERLOOK
- 14 "RIVER ISLANDS"
- 15 BEACH
- 16 ON-STREET BICYCLE LANES



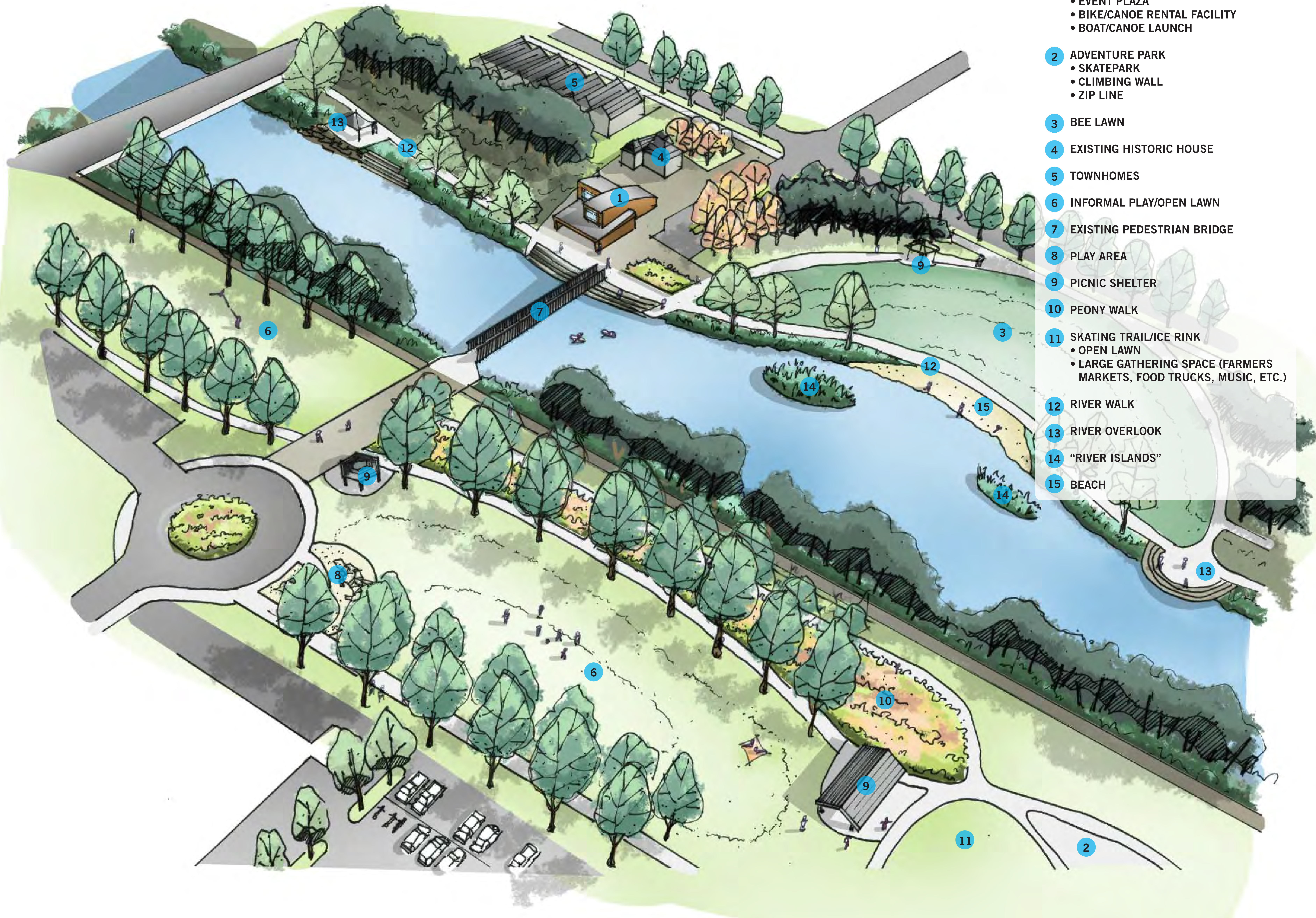

- 1 RECREATION PAVILION
  - EVENT PLAZA
  - BIKE/CANOE RENTAL FACILITY
  - BOAT/CANOE LAUNCH
- 2 ADVENTURE PARK
  - SKATEPARK
  - CLIMBING WALL
  - ZIP LINE
- 3 BEE LAWN
- 4 EXISTING HISTORIC HOUSE
- 5 TOWNHOMES
- 6 INFORMAL PLAY/OPEN LAWN
- 7 EXISTING PEDESTRIAN BRIDGE
- 8 PLAY AREA
- 9 PICNIC SHELTER
- 10 PEONY WALK
- 11 SKATING TRAIL/ICE RINK
  - OPEN LAWN
  - LARGE GATHERING SPACE (FARMERS MARKETS, FOOD TRUCKS, MUSIC, ETC.)
- 12 RIVER WALK
- 13 RIVER OVERLOOK
- 14 "RIVER ISLANDS"
- 15 BEACH



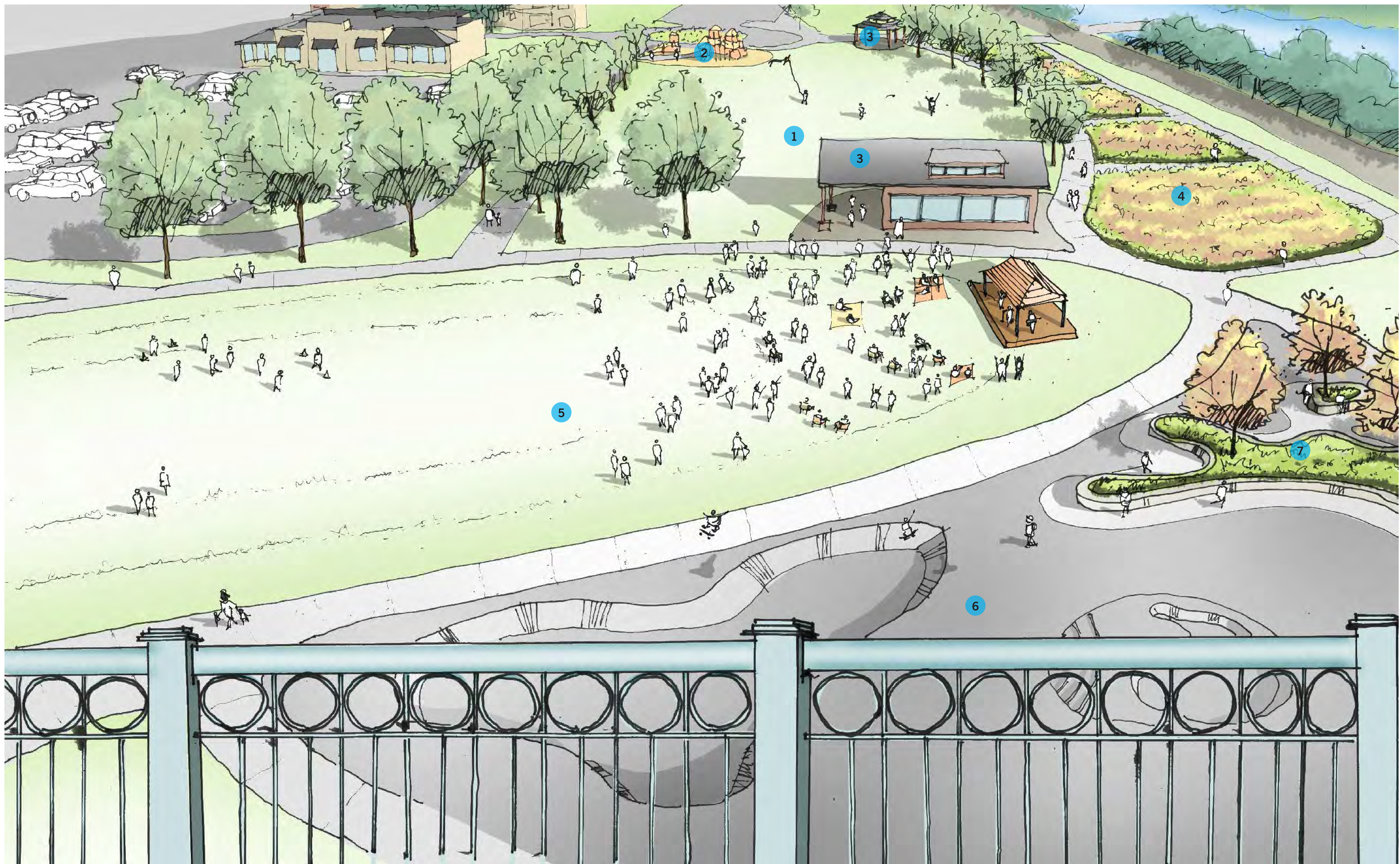

- 1 INFORMAL PLAY/OPEN LAWN
- 2 PLAY AREA
- 3 PICNIC SHELTER
- 4 PEONY WALK
- 5 SKATING TRAIL/ICE RINK
  - OPEN LAWN
  - LARGE GATHERING SPACE (FARMERS MARKETS, FOOD TRUCKS, MUSIC, ETC.)

- 6 ADVENTURE PARK
- 7 SKATING LOOP









- 1 MARKET-DRIVEN DEVELOPMENT
  - HOUSING
  - OFFICES
- 2 TOWNHOMES
- 3 STORMWATER
- 4 ADVENTURE PARK
  - SKATEPARK
  - CLIMBING WALL
  - ZIP LINE
- 5 PUBLIC PARKING



- 1 MARKET-DRIVEN DEVELOPMENT
  - HOUSING
  - OFFICES
  - STREET-FACING RETAIL
- 2 TOWNHOMES
- 3 LAWN
- 4 BEACH
- 5 PEDESTRIAN BRIDGE
- 6 PEDESTRIAN PROMENADE
- 7 RIVER OVERLOOK & STEPS
- 8 RIVER WALK







**1 MARKET-DRIVEN DEVELOPMENT**  
 • HOUSING  
 • OFFICES  
 • STREET-FACING RETAIL

**2 TOWNHOMES**

**3 LAWN**

**4 BEACH**

**5 PEDESTRIAN BRIDGE**

**6 PEDESTRIAN PROMENADE**

**7 RIVER WALK**